



Kink Valve Repair Kit [002-1392-00]

Components:

Uni-Clamp, 1/8" OD.....	25
Barbed Fitting 1/8" to 1/8".....	5
Barbed Fitting 1/16" to 1/16".....	10
Tubing, 1/8" OD White.....	2'
Tubing, 1/8" OD Blue.....	2'
Tubing, 1/4" OD Clear.....	2'

WARNING
 Turn off the master switch before opening the lid on the delivery unit. Failure to do so may cause injury.

Step 1: Verify that control knobs adjust the proper handpieces.

- Pull handpiece A from holder.
- Step on foot pedal to activate desired operation.
- Adjust control knobs for handpiece A and verify responses.
- Repeat to identify which knobs work each handpiece.

Note: Delivery units can have up to five handpieces and a syringe - your unit may not look exactly like the illustrations shown here.

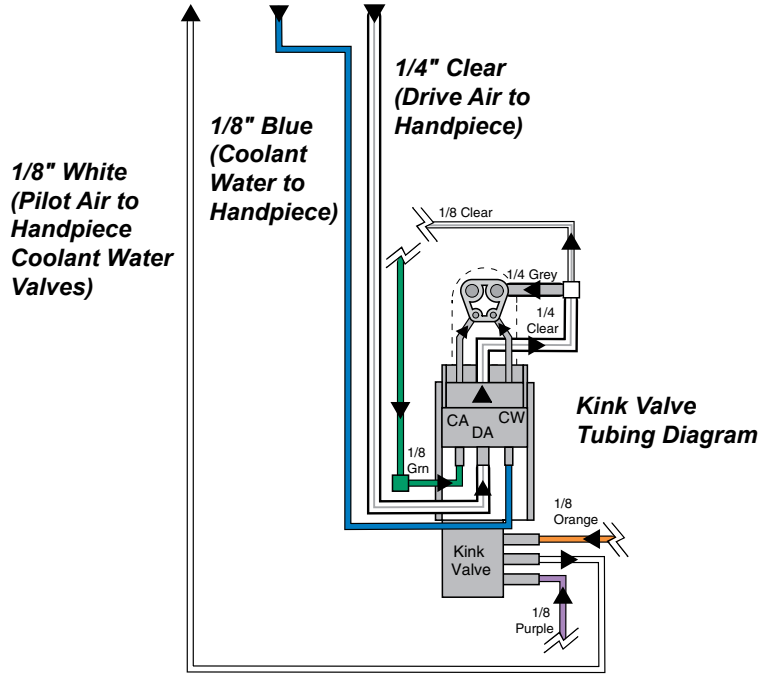
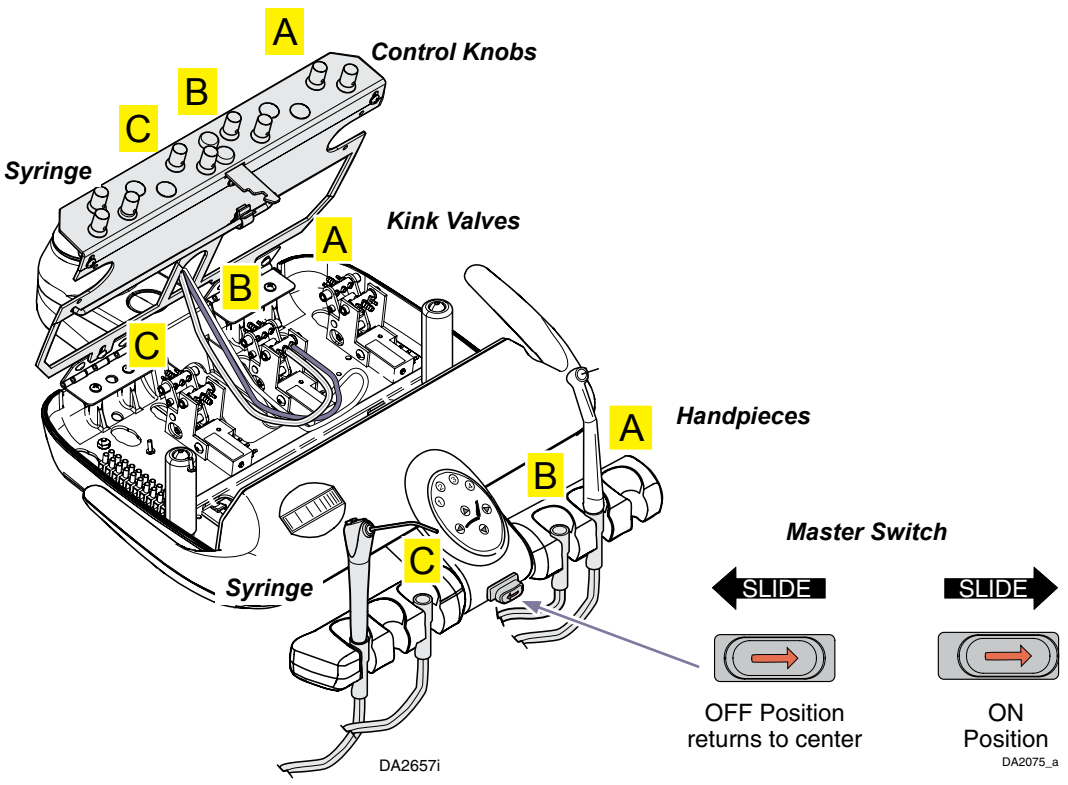

Step 2: Reconnect kink valves when necessary.

- Turn off the master switch.
- Disconnect tubing called out in the kink valve tubing diagram from incorrect kink valve.
- Cut additional tubing length required to reach correct kink valve.
- Use uni-clamps and barbed fittings provided to connect tubing to the correct kink valve.
- Repeat for all kink valves.

Step 3: Test all handpieces to verify kink valve connections.

- A) Close the lid on the delivery unit.
- B) Turn on the master switch.
- C) Pull handpiece A from holder.
- D) Step on foot pedal to activate desired operation.
- E) Adjust control knobs for handpiece A and verify responses.
- F) Repeat to verify control connections on all handpieces.

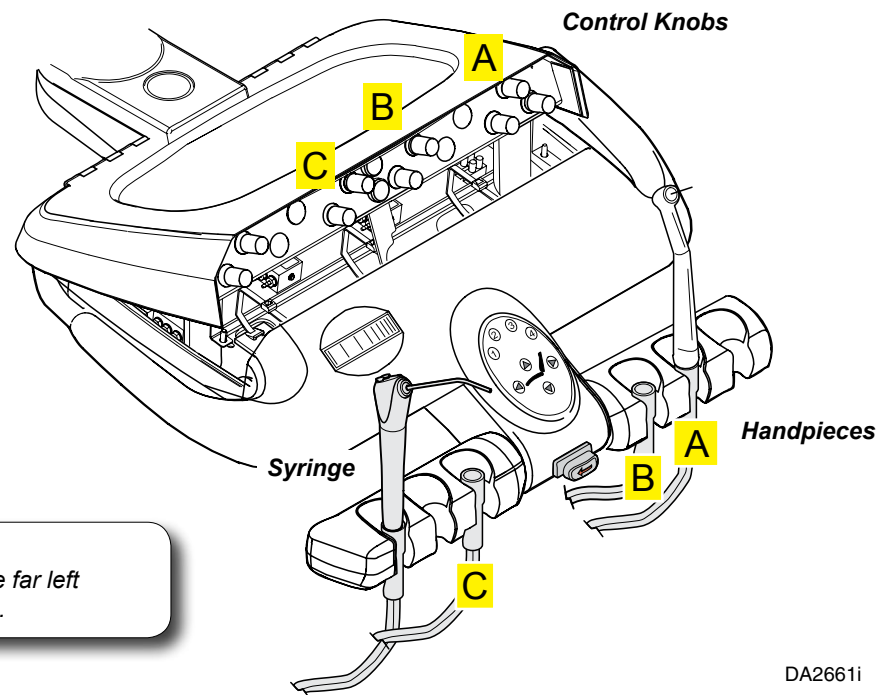

Equipment Alert

The syringe is commonly mounted in the far left holder, in line with syringe control knobs.

Operating Handpieces

Handpieces can deliver water and air dependant on the setting of the Water Selector footswitch.

To Operate handpiece...

- A) Turn Master Switch ON
- B) Move Water Selector Switch to desired setting.
- C) Remove handpiece from holder.
- D) Press foot pedal to deliver the selected drive air/water to the handpiece.

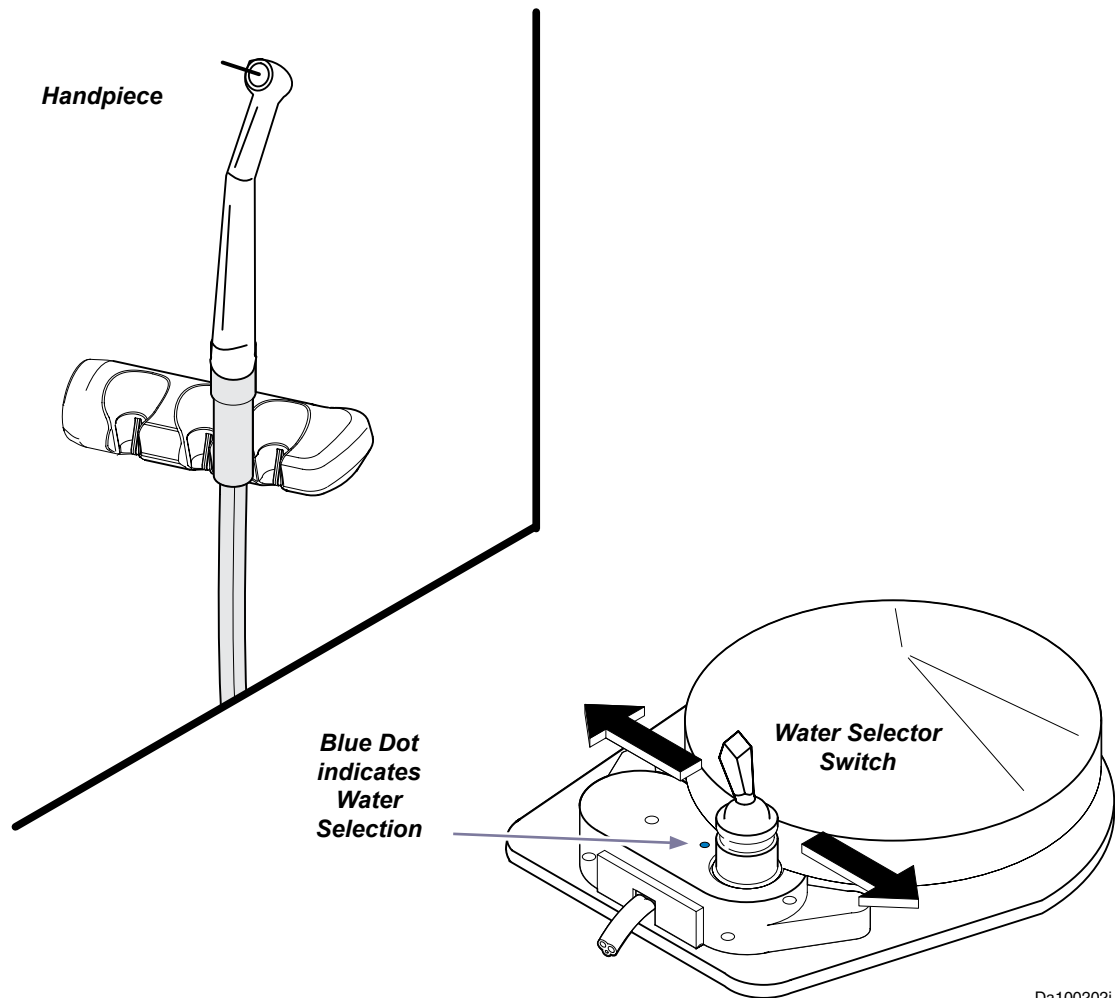

Handpiece Controls

Each handpiece has its own Drive Air control knob and its own Coolant Water control knob. There is also a Coolant Air control knob that adjusts the coolant air **for all handpieces**.

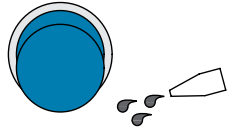

To adjust the Coolant Water...

Rotate the Coolant Water control knob for the desired handpiece, until the desired flow is achieved.

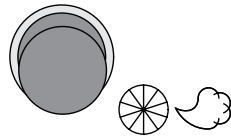

To adjust the Drive Air pressure...

Rotate the Drive Air control knob for the desired handpiece, until the desired air pressure registers on the pressure gauge.

Note: Refer to the handpiece manufacturer's literature for the recommended pressure setting.

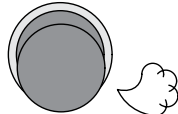

DA2531

To adjust the air/water Spray Pattern...

Rotate the Coolant Air control knob until the desired pattern is achieved.

Note: If your handpiece has an internal coolant air connection this adjustment will have no effect.